

Date	Rev. date	Work nr.	Drw. nr.	Rev.
Drawn by Ruukki	Rev.	N29/S04	-	
Scale 1:2	Building		File nr. P2021/001-00035	

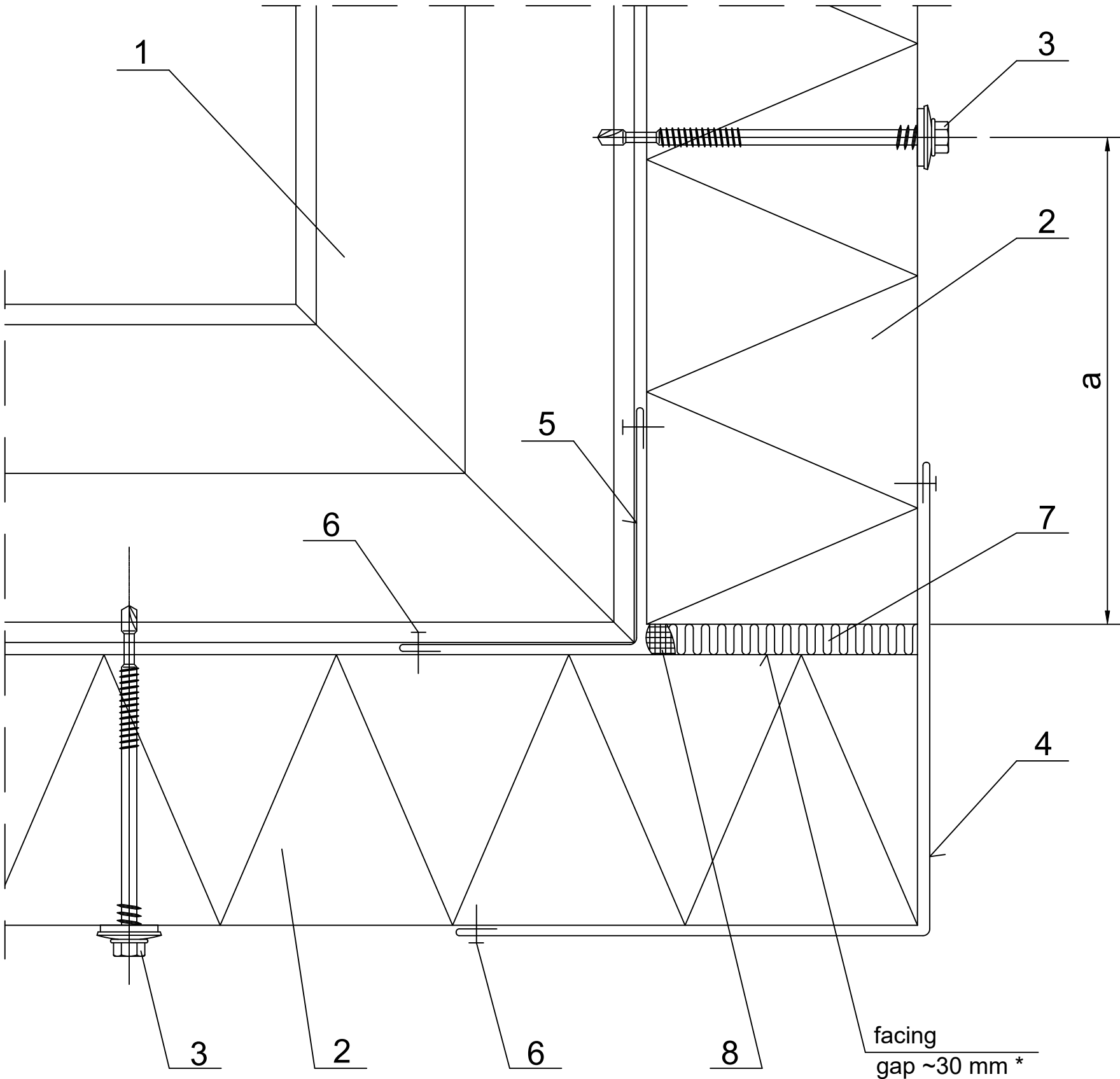

- 1. Steel sheeting rail acc. to engineering design of the structure .
- 2. Ruukki nSPB W / nSPB WS / nSPB WE / nSPB WF.
- 3. Panel fastener for hot-rolled sheeting rail or for cold-bent sheeting rail.
- 4. EA1B03 corner flashing .
- 5. EA1B05 corner flashing .
- 6. Steel rivet (every 300 mm).
- 7. Loose mineral wool.
- 8. Permanently elastic sealing compound.

panel thickness [mm]	min. distance from the panel edge "a" [mm]
< 150	30
≥ 150	40

* for structures with high requirements regarding thermal insulation facing gap is ~30 mm;